

### Fan Components and Material Properties

ARS-FC double suction crossflow fans operate at high efficiency and low noise level. Manufactured from high quality galvanized steel resistant to corrosion. The motor and fan impeller are connected to the main body by aluminum carriers. The external rotor motor is used to create a compact structure and the device is max. It is capable of carrying air at a temperature of 40°C.

### Fan Structure

The forward sloped fan wheel is made of high quality galvanized steel which is resistant to corrosion and they are manufactured in aerodynamic structure to ensure regular flow. Thanks to its aerodynamic wing structure, it works quietly.

TYPE	A	B	C	D	E	F	G	H	J	K	L	M	N	O
ARS-RFC 133-146	208	101	214	118	231	200	226	242	256	95	112	126	06	2

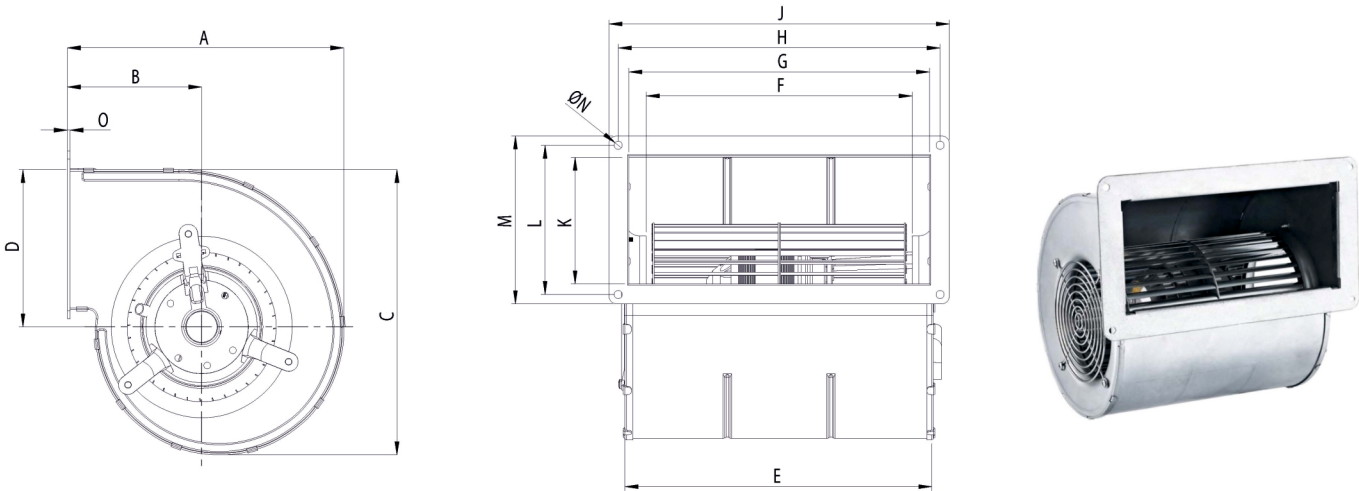

TYPE	VOLTAGE	FREQUENCY	POWER	CURRENT	CAPACITOR	SPEED	AIR FLOW	SOUND PRESSURE	INSULATION CLASS	PROTECTION CLASS	WEIGHT
	V	Hz	W	(A)	( $\mu$ F)	D/dak	m <sup>3</sup> /h	dB(A)	iz. Kl.	IP	Kg
ARS-RFC 133-2K	230	50/60	200/210	0,95/1	4	1300/1150	810/715	56	B	44	4,7
ARS-RFC 133-4K	230	50/60	95/110	0,42/0,49	3	1200/1150	750/720	55	B	44	4,7
ARS-RFC 146-2K	230	50/60	300/355	1,3/1,45	7	2000	1100	63	B	44	5
ARS-RFC 146-4K	230	50/60	95/115	0,42/0,50	3	1000/1130	775/875	62	B	44	5

### Fan Components and Material Properties

Fan Body and fan are made of high quality galva-nized steel which is resitant to corrosion. DD double suction centrifugal fans operate at high ef-ficiency. It has a self-asynchronous motor and is connected to the motor frame by steel carries.

### Fan Structure

Double suction, forward-curved low pressure ra-dialtype fan. The fan wheel is made of high qual-ity galvanized steel which is resistant to corrosion and is manufactured in aerodynamic structure to ensure regular flow. Thanks to its aerodynamic wing structure, it works quietly.

### Benefits

It produces high flow rate with its frequent wing structure. It takes less space than fans with belt-pilley mechanisms; It is easy to assemble. With the mounting legs, the air shot directions can be ad-justed. Adjustable with speed control devices.

### Technical Drawing and Tables

TYPE	A	B	C	D	E	F	G	J	K	L	M	H1	H2	H3	X1	X2	X3
ARS-DRFC 7-7	313	333	207	190	154	225	250	236	265	288	55	143	195	167	81	93	73
ARS-DRFC 9-9	381	400	261	218	186	300	330	296	325	350	45	182	245	209	115	115	98
ARS-DRFC 10-10	425	455	290	250	197	339	370	333	361	386	40	206	258	238	139	145	178
ARS-DRFC 12-12	490	535	336	292	229	410	440	398	429	454	35	243	292	270	152	152	186

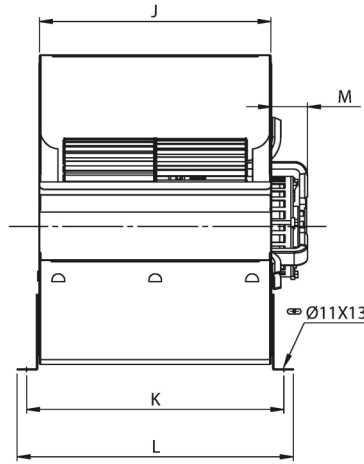
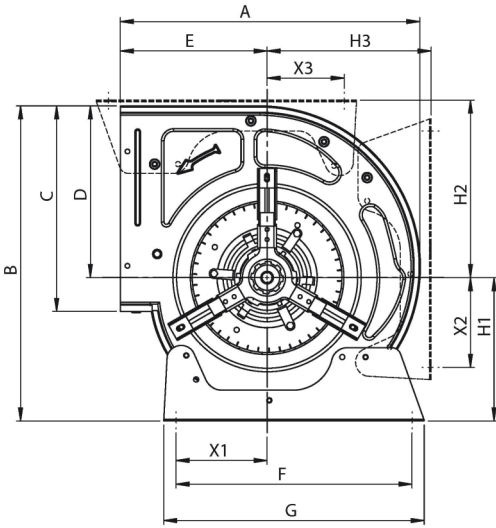

TYPE	VOLTAGE	FREQUENCY	POWER	CURRENT	CAPACITOR	SPEED	AIR FLOW	SOUND PRESSURE	NSULATION CLASS	PROTECTION CLASS	WEIGHT
	V	Hz	W	(A)	(µF)	D/dak	m³/h	dB(A)	iz. Kl.	IP	Kg
ARS-DRFC 7-7	230	50	147	2,2	10	1300	1800	60	B	54	9
ARS-DRFC 9-9	230	50	370	3,6	20	1300	2875	62	B	54	13
ARS-DRFC 10-10	230	50	600	4,2	20	1380	3425	66	B	54	15
ARS-DRFC 12-12	230	50	1100	5,8	30	900	5180	62	B	54	16